

ALL DIMENSIONS ARE IN METRES
SCALE:- 1" = 8'-0" (1:100) OFFICE COPY

PLAN SHOWING THE PROPOSED CONSTRUCTION OF STILT + 3 FLOORS SHOP CUM (SHOP) 1st FLOOR RESIDENTIAL BUILDING WITH 4 DWELLING UNITS AT OLD DOOR NO: 72, NEW DOOR NO: 25 & OLD DOOR NO: 26, NEW DOOR NO: 72/2 KUPPUMUTHU STREET, TRIPLICANE, CHENNAI - 600 005. COMPRISED IN P.S. NO: 449/2, 449/3, 449/4 & 450/1, BLOCK NO: 15, TRIPLICANE VILLAGE, MYLAPORE TALUK, CHENNAI DISTRICT. CORPORATION OF GREATER CHENNAI. DIVISION NO: 114, ZONE: 09

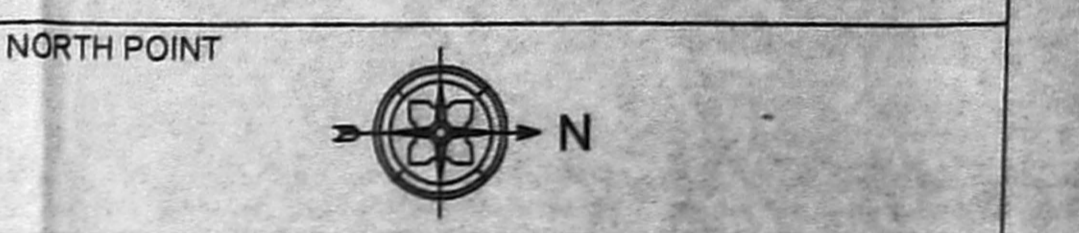

SCHEDULE OF JOINERY

ED	DOOR	1.20 x 2.13
D1	DOOR	0.91 x 2.13
D2	DOOR	0.76 x 2.13
W1	WINDOW	1.60 x 1.80
W2	WINDOW	1.20 x 1.80
V1	VENTILATOR	0.61 x 0.91

AREA STATEMENT

	SQ.M
AS PER PATTA	408.42
AS PER DOCUMENT	407.50

FLOORS

FLOORS	FSI AREA (SQM)	No. of Dwelling Unit
STILT FLOOR	-	-
FIRST FLOOR (SHOP)	283.27	-
SECOND FLOOR	283.27	2
THIRD FLOOR	283.27	2
TOTAL	849.81	-
F.S.I. ACHIEVED	2.085	-

CAR PARKING PROVIDED = 08 nos
TWO WHEELERS PARKING PROVIDED = 04 nos

COLOUR INDEX:-

PROPOSED	[Color Box]
BOUNDARY	[Color Box]
ROAD	[Color Box]

OWNER: [Signature]

ARCHITECT: DHINESH T
No. 10/1, Second Street, Kashturba Nagar, Avadi, Chennai-600 054.

LICENSED SURVEYOR